

BYU Campus Map

Physical Facilities Division

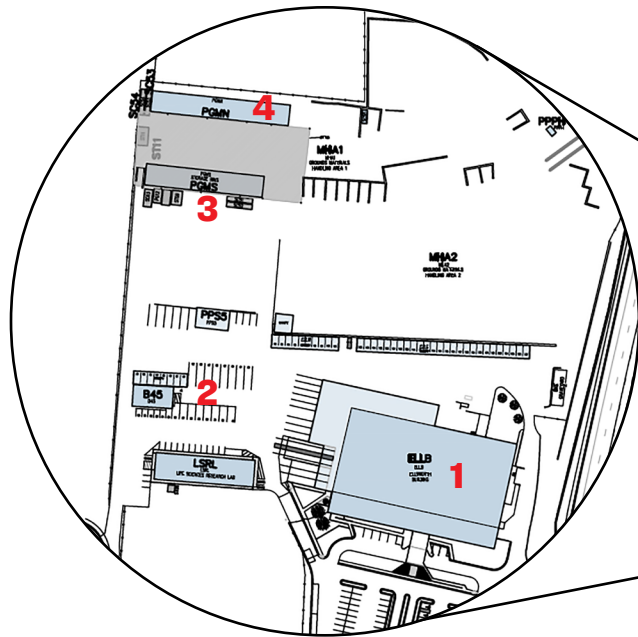

Ellsworth Building & Recycling

1. Ellsworth Building
 - a. Flooring & Upholstery
 - b. Moving, Receiving, & Office Furniture
 - c. Surplus
2. Covered University Vehicle Storage
3. Recycling
4. Grounds Material Handling Area

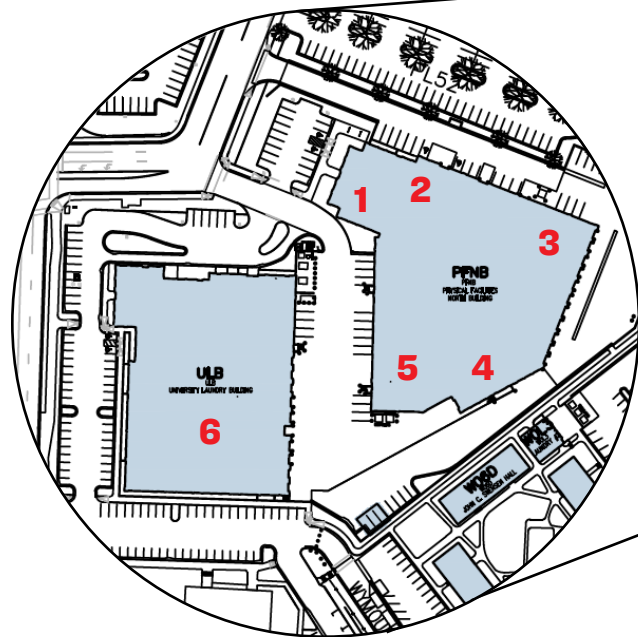

Physical Facilities North Building

1. Building Operations
2. Dining & MTC Maintenance / Housing HVAC & Maintenance
3. Equipment Repair
4. Roofing, Glass, & Exteriors
5. Warehouse
6. University Laundry Building

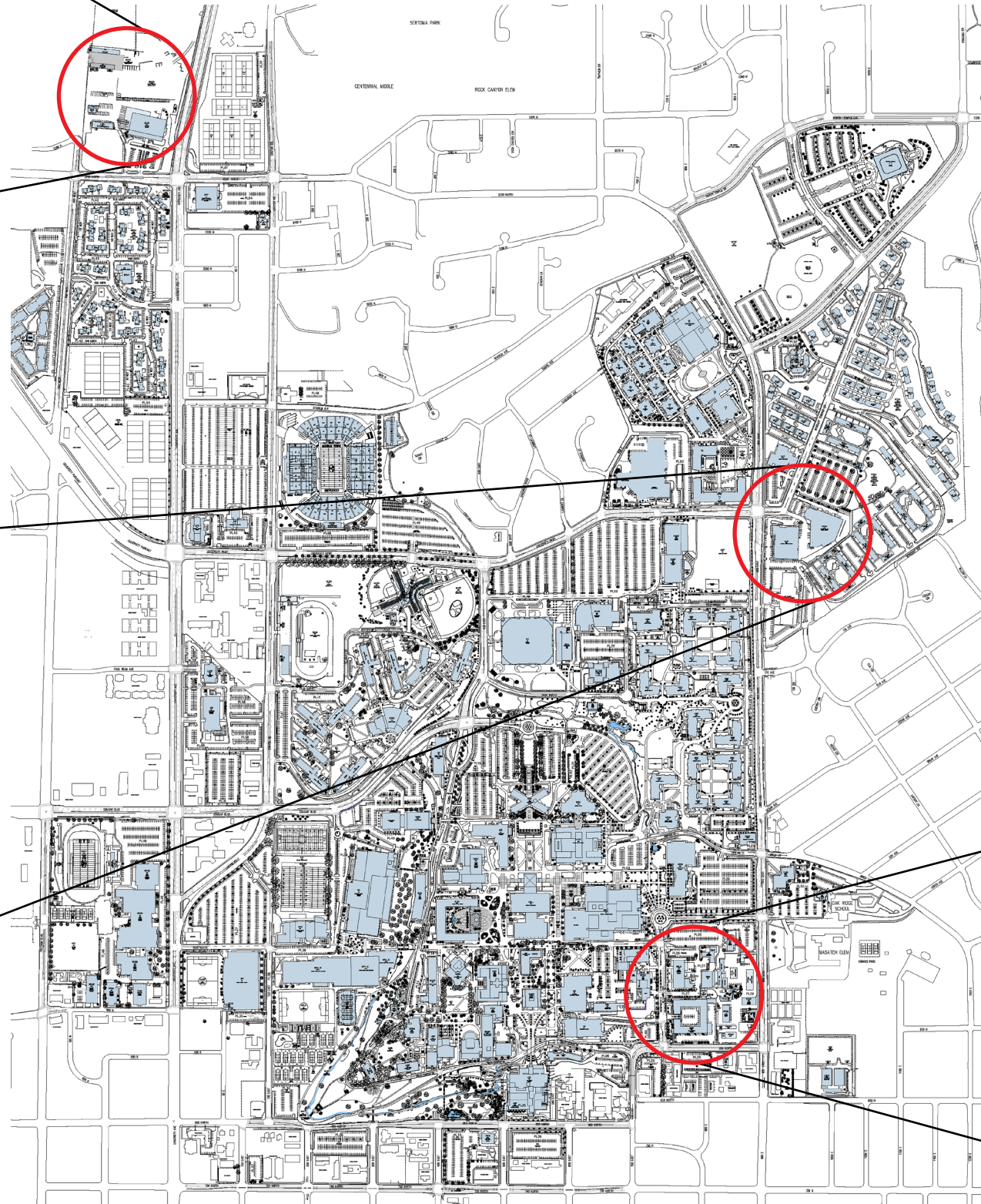

Brewster Building & Central Heating Plant

1. Central Heating Plant
2. Brewster Building
 - a. AAVP-PF Office
 - b. Buildings, Grounds, & Transportation Services
 - i. Air Conditioning Shop
 - ii. Carpenter Shop
 - iii. Electrical Shop
 - iv. Grounds & Landscape Management
 - v. Keys, Locks, & Access Control
 - vi. Paint & Sign Shop
 - vii. Plumbing & Mechanical Shop
 - viii. Transportation & Manufacturing Services
 - c. Business Support & Compliance
 - i. Safety & Compliance
 - ii. Information Support
 - iii. Payroll
 - iv. Work Orders & Project Requests
 - d. Capital Needs & Utilities Analysis (CNA)
 - e. Facilities Planning & Design - Campus Projects
 - i. Architectural & Interior Design
 - ii. BIM/CAD Management
 - iii. Civil Engineering & Landscape Architecture
 - iv. Cost Estimating
 - v. Electrical, Mechanical, & Structural Engineering
 - vi. Space Management
 - f. Planning & Construction - Major Projects
 - i. Architectural Programming
 - ii. Building Design
 - iii. Commissioning
 - iv. Construction
3. Service Station
4. Vehicle Rental
5. Transportation Services Tool Room
6. Grounds Greenhouse, Storage, & Vehicle Shelters

